

### Pack contents

1. 2 x Hanger and Bolt
2. 2 x Mounting brackets
3. 8 x Fixing screws
4. 1 x Spanner

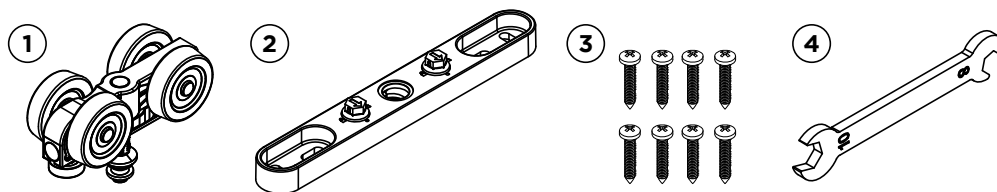

### Track and channel options

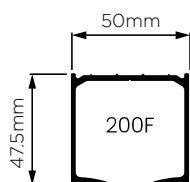

200F for 200kg systems

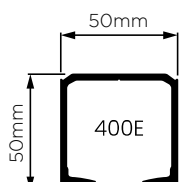

400E and 400F for 400kg systems

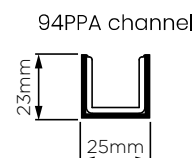
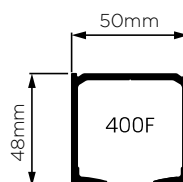

### 1. Track and channel installation

Fix track with screws starting with 35mm from each end and then at 400mm intervals

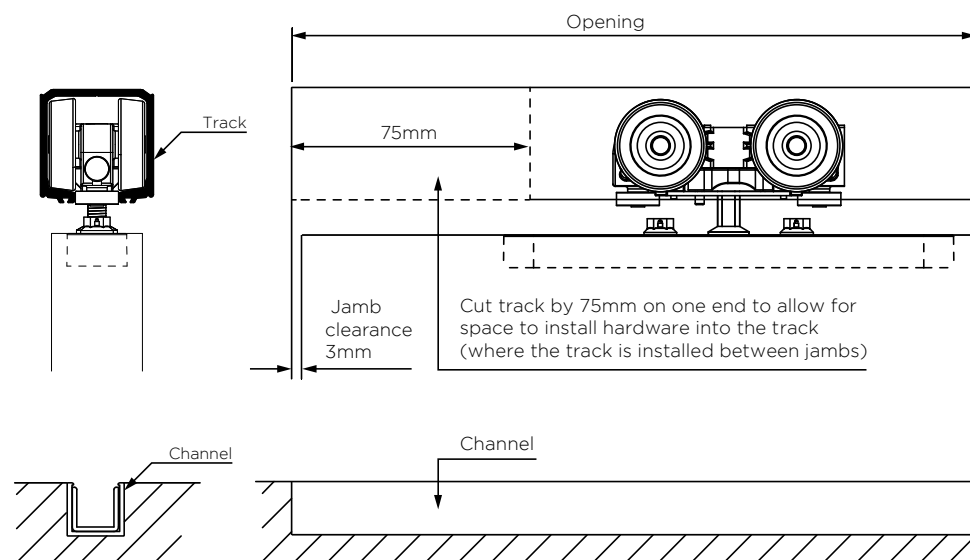

Ensure track is installed parallel to the wall

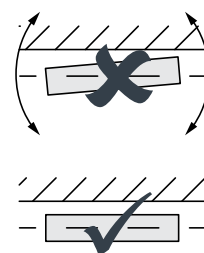

Once track and channel are installed, ensure that all dust, swarf or contamination is removed from the inside of the track before fitting any hardware.

If installing 94PPA, cut length to opening, countersink and fix screws 35mm from each end then fix at 400mm intervals. Install 94P polypropylene infill last.

### 2. Panel preparation

Use a bracket as a template to mark the hole position on the panel. Make sure both brackets are in the same orientation

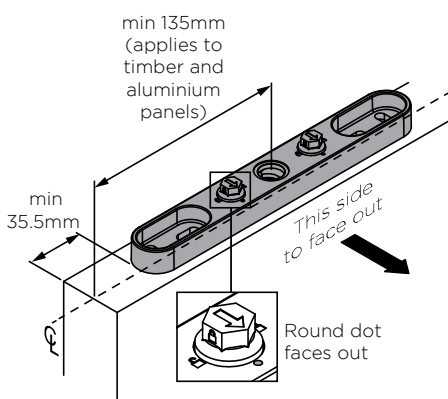

Route 14.5mm recessed slot (**timber only**) and pre-drill holes for 12G screws

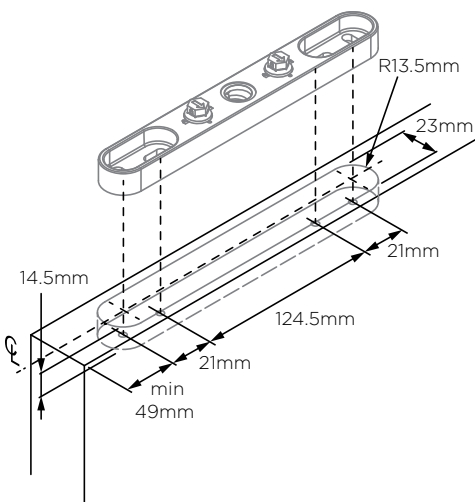

Aluminium panel recess specifications

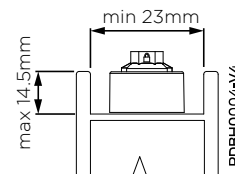

Fix bracket with mounting screws provided

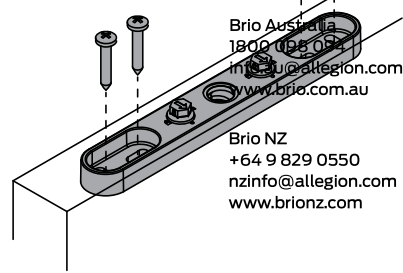

Brio Australia  
1800 068 092  
info@allegion.com  
www.brio.com.au

Brio NZ  
+64 9 829 0550  
nzinfo@allegion.com  
www.brionz.com

### 3. Hardware installation

Insert hardware into the track following the appropriate instructions to install soft close/s or dampener stop/s as required

Side elevation shown with dampener stops used on both ends

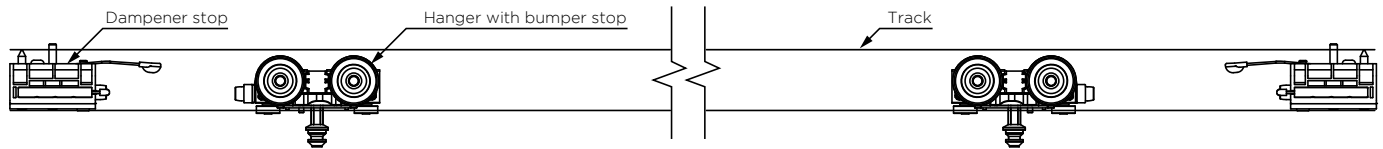

Side elevation shown with soft closers used on both ends

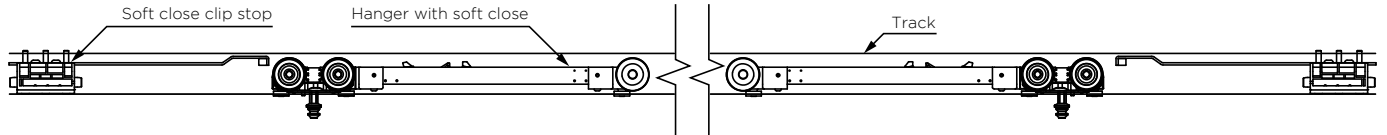

### 4. Attach panel to hanger

**4.1** Check both brackets to ensure locking hex is on the installation position before attaching to hanger

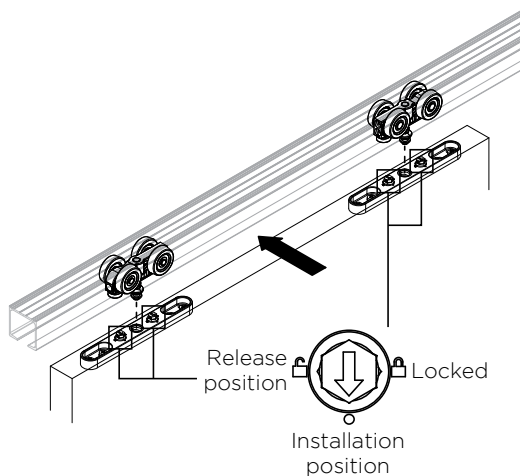

**4.2** Carefully lift the door with the brackets, line up the opening of the bracket with the bolt on the hangers until the bolt locks into the bracket

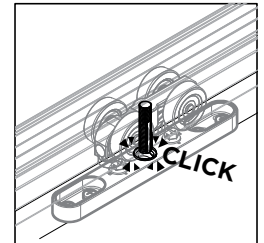
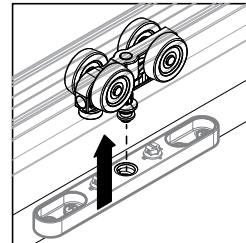

**Note:** The panel needs to be lifted up 13.5mm for bolt locking. Adjusting the height of the bolt on hanger for more clearance when necessary

**Note:** Once the hanger engages the bracket the bolt clicks into place

**4.3** Lock the bolt by turning the locking hex to the locked position using the spanner

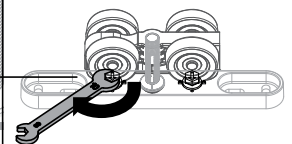
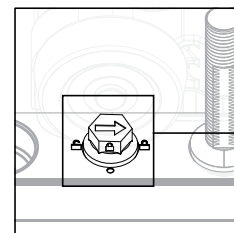

### 5. Height adjustment

**5.1** Unlock the bolt by moving the switch to the unlocking position. Line up peg on the spanner to the locking button and press.

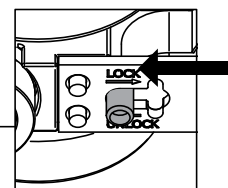
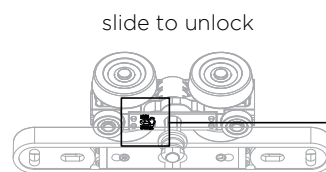
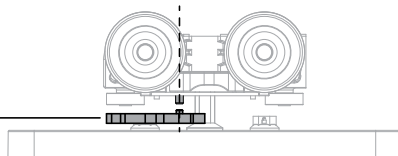
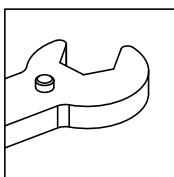

**5.2** Adjust the height by using the 8mm opening on the spanner to rotate the bolt. Anti-clockwise to raise and clockwise to lower the panel

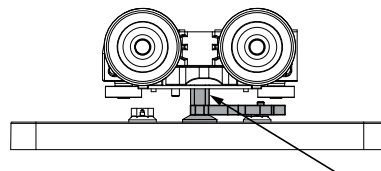
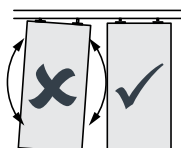
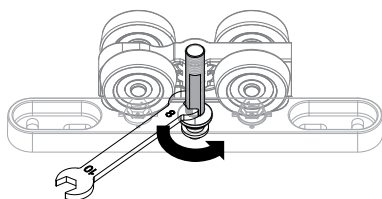

Ensure flat surface of the bolt is facing the front after height adjustment is completed

Spanner to be applied on flat surfaces of the bolt



**ALLEGION™**

**5.3** Lock the bolt by moving the switch to the locking position

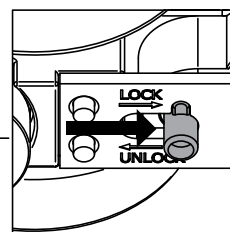
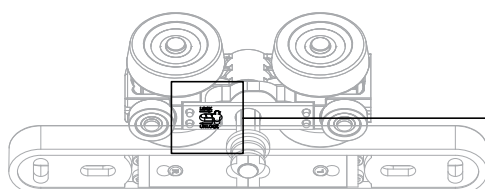

Brio Australia  
1800 098 094  
info.au@allegion.com  
www.brio.com.au

Brio NZ  
+64 9 829 0550  
nzinfo@allegion.com  
www.brionz.com

6. Release the panel

Turn the locking hex to the release position using the spanner

Remove the panel

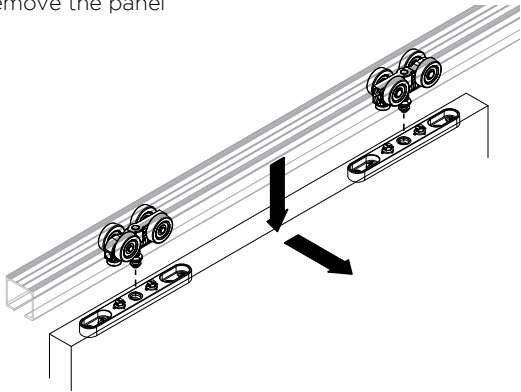
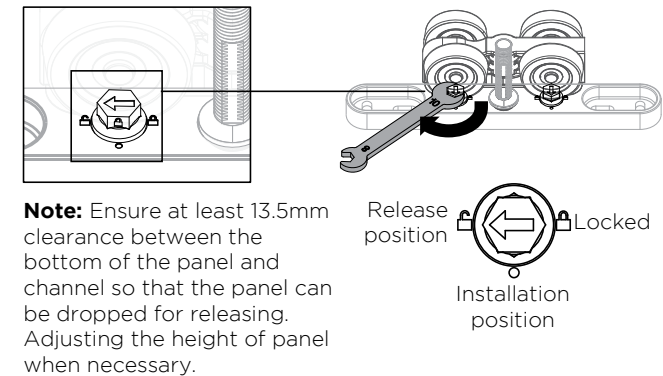

7. System overview

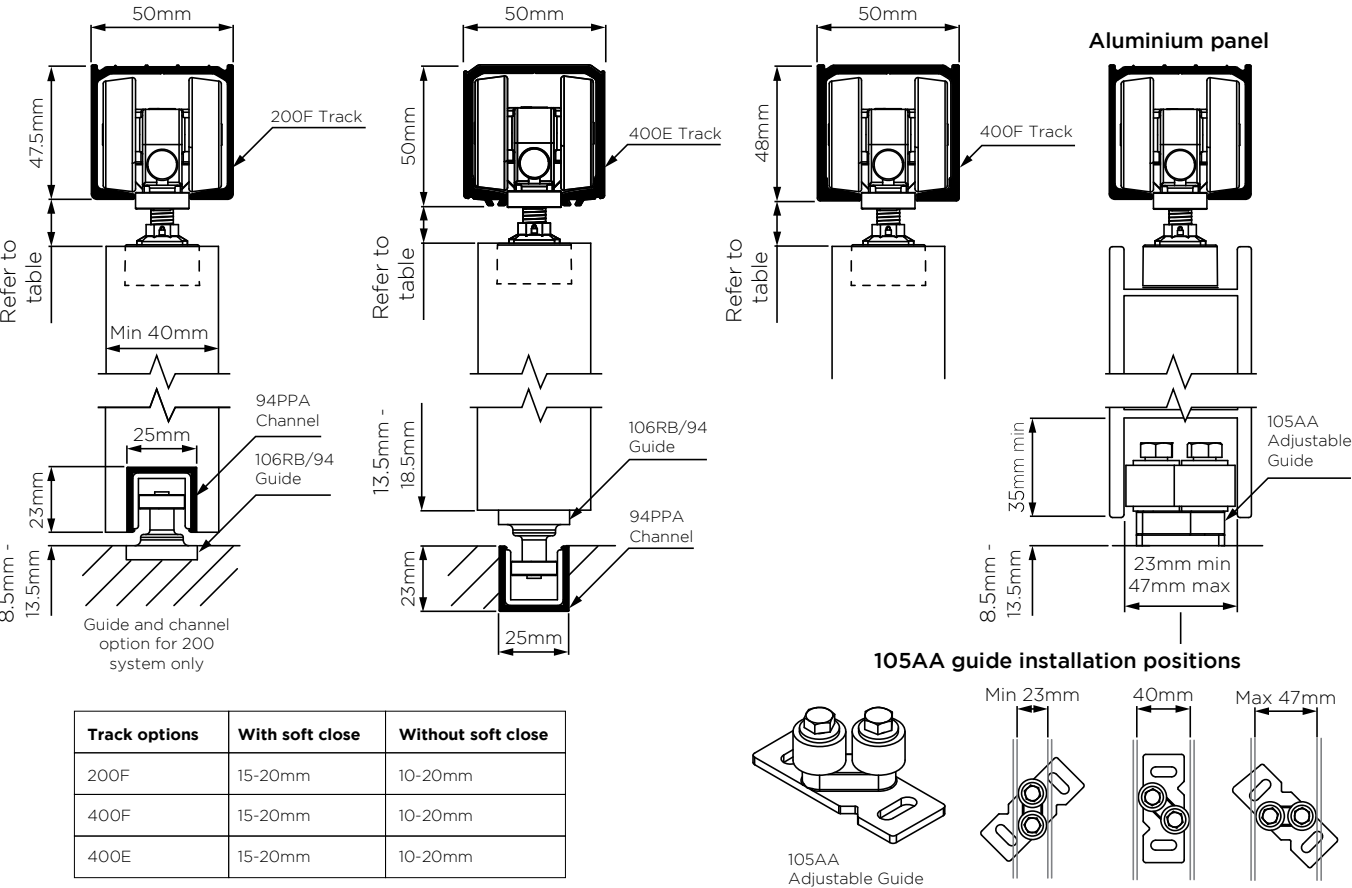

Care and maintenance

General

Inspect all fixing bolts for tightness every six months, including those securing brackets. Tighten if necessary. Routinely check for wear and if excessively worn, the part should be replaced.

To help prevent surface corrosion, wash regularly with soap or mild detergent and warm water followed by rinsing with clean cold water and dry.

Track

Keep track free from obstruction and excessive dirt or water. Visible surfaces should be cleaned using a damp cloth and mild detergent, then wiped dry.

Hangers

All hangers are fitted with lubricated ball-bearings, requiring no greasing. If doors 'settle' and door clearance is reduced causing friction, raise the door by the hanger adjustment nuts. Wash as per the above recommendation and apply a light application of corrosion preventative to all surfaces, using a dry cloth to remove excess.

Guides

Guide roller and guide channel must be kept clear and free of obstructions. Wash as per the above recommendation and apply a light application of corrosion preventative to all surfaces, using a dry cloth to remove excess.



Brio Australia  
1800 098 094  
info.au@allegion.com  
www.brio.com.au

Brio NZ  
+64 9 829 0550  
nzinfo@allegion.com  
www.brionz.com